

IT'S ALL ABOUT LOCATION, LOCATION, LOCATION.
BOOK YOUR BEST SPOT IN THE HEART OF A THRIVING COMMUNITY!

TAMAN
RIANG
@ BUTTERWORTH



TAMAN
RIANG
@ BUTTERWORTH

CALL US NOW!

1800-188-333 | 04-380 6000 | 011-1722 5711

 airmasgroup | 水金集团
www.airmas.com

AIRMAS GROUP 

No. 33 Jalan Jelawat, Seberang Jaya,
13700 Perai, Penang, Malaysia

F: +604 380 6001
E: sales@airmas.com

您的欢乐家园

HAPPY TO BE HOME

FREEHOLD LANDED RESIDENCES

DISCLAIMER : All information including but not limited designs, drawings, concepts, photos, images, brochures, perspectives, articles and plans contained in this website ("Information") are subject to change without prior notice and cannot form part of any offer or contract. All photos, images, brochures, illustrations shown are artist's impressions only. While every effort has been taken to provide accurate information, the developer reserves the right to upgrade, modify, alter, suspend, discontinue or remove, whether in whole or in part, this brochure and/or any information or products provided therein from time to time without giving any reason(s) and/or prior notice.

TAMAN RIANG

@ BUTTERWORTH

Live Abundantly

Ever wanted a home that's strategically located in the centre of Butterworth town and still only a stone's throw away from Penang island? How would you like to live amidst an established residential neighbourhood that already has complete public amenities around the corner? Or a shopping mall within walking distances of your doorstep? That would be pretty convenient.

Well, here at Taman Riang, it is all an exciting reality. New spacious landed residences from 1,600 to 2,300 square feet, have been designed for those yearning for a home that is part nature, part city. Live abundantly with rich greenery around you, everything else near you and the joy of being part of a safe, happy and thriving community.

充实生活

您是否想拥有一间位于北海市中心却距离槟岛仅一石之遥的家? 您是否想在有完善设施的住宅区中生活? 您是否想购物中心就在步行距离之内? 别犹豫了!

Taman Riang 将会是您的完美家园, 让您的期望实现。建筑面积从1600至2300平方尺, 明朗、宽敞、舒适, 是为渴望拥有一间家的您而精心设计的。Taman Riang 为您带来充实的生活。

Site Plan

规划蓝图

Floor Plan

平面图

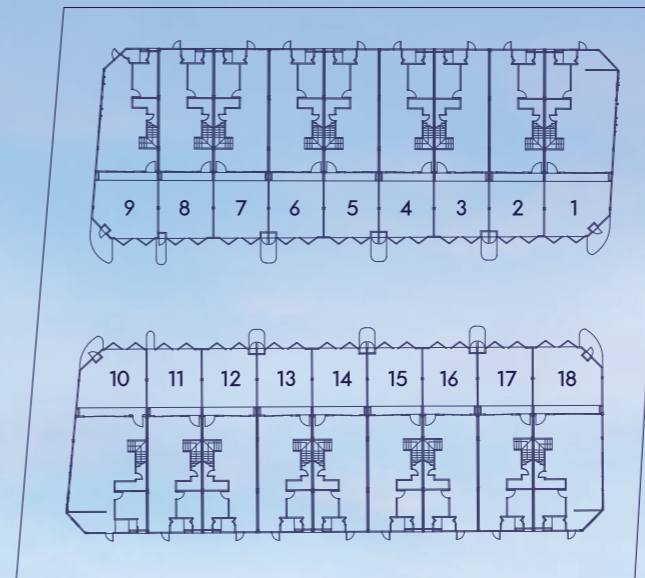

Plot 1 - 9

A 型 | Type A
1,700 s.f. onwards

Plot 10 - 18

B 型 | Type B
1,600 s.f. onwards

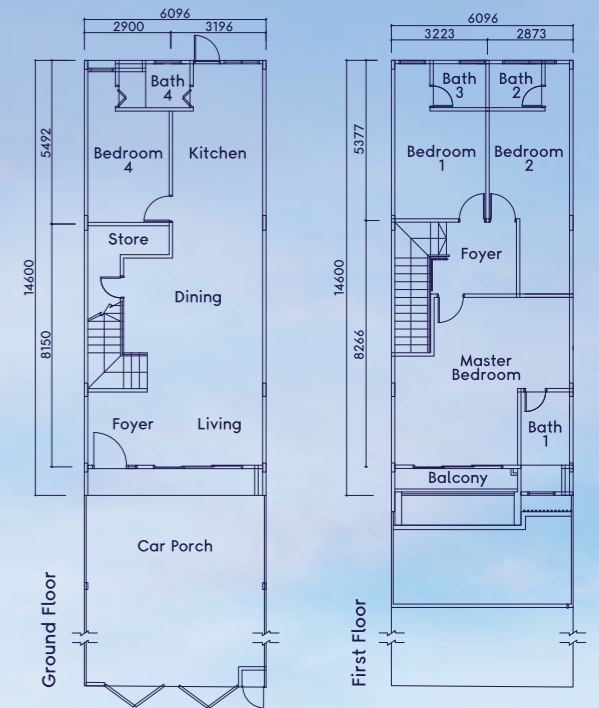

A 型 | Type A



1,600 s.f. onwards
Perfect for any family size
1,600平方尺起
为家家户户制定绝佳的居住空间



4 En-suite Bathrooms
For increased comfort and privacy
4间独立的浴室
提供便利和隐私



4 Sizeable Bedrooms
Ample living space for every family member
4间巨大的卧室
让家庭成员享用充裕的生活空间



Peaceful Environment
Set amidst rich natural surroundings
舒畅的环境
位于自然风景区



Strategic Location
Easy access to major hubs, transport links and Penang Bridge
优良的位置
便于主要枢纽、交通联系以及槟威大桥



Established Neighbourhood
Peaceful community near complete amenities, food and entertainment
建立的邻里
和平的社区近于齐全的设施、美食以及娱乐空间